



Visit resexpo.com
for online services

VU Case Rentals

Please Mail, Email or Fax Completed Form to RES:
9291 West Bryn Mawr, Rosemont, IL 60018
Email: customerservice@rosemontexpo.com
Fax: 847-696-9797
Phone: 847-696-2208

SAE 2011 Commercial Vehicle Engineering Congress
September 13-14, 2011

For detailed information and questions, please call
VU Case Rentals, Inc. at 630-766-7443

**Deadline Date To Receive Discounted Rates:
August 25, 2011**

FULL VISION CASE

Includes 1-8" and 1-10" glass shelf
with adjustable brackets, 26" high front
glass display section

	QTY.	DISCOUNT	STANDARD	TOTAL
5 ft.	_____	\$325.00	\$375.00	_____
6 ft.	_____	\$350.00	\$400.00	_____

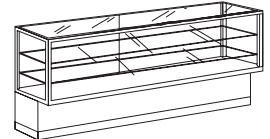

FULL VISION CASE

HALF VISION CASE

Includes 1-10" glass shelf with adjustable
brackets, 18" high front glass display section

5 ft.	_____	\$325.00	\$375.00	_____
6 ft.	_____	\$350.00	\$400.00	_____

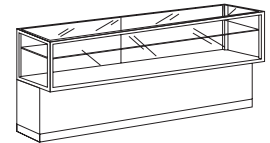

HALF VISION CASE

QUARTER VISION CASE

with 12" high front glass display section

5 ft.	_____	\$325.00	\$375.00	_____
6 ft.	_____	\$350.00	\$400.00	_____

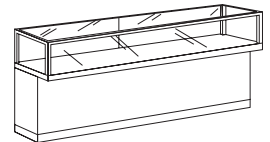

QUARTER VISION CASE

CORNER VISION CASE

Rear access, glass shelves same as above

Full Vision	_____	\$350.00	\$400.00	_____
1/2 Vision	_____	\$325.00	\$375.00	_____
1/4 Vision	_____	\$325.00	\$375.00	_____

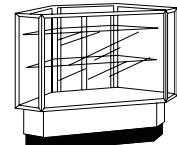

CORNER FULL VISION

WALL CASES ARE:

48" L x 20" D x 66" H, with 4-12" glass
shelves, adjustable brackets, lights, locks
and 60" high sliding glass doors

Solid	_____	\$350.00	\$400.00	_____
See-Thru	_____	\$350.00	\$400.00	_____

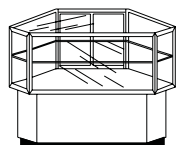

CORNER 1/2 VISION

TOWER CASES

20" L x 20" D x 80" H, with 3 glass, lights,
and locks

20" x 20" Sq.	_____	\$350.00	\$400.00	_____
---------------	-------	----------	----------	-------

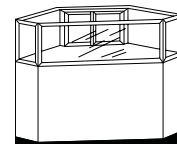

CORNER 1/4 VISION

Order Total \$

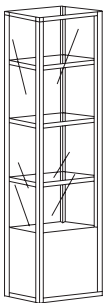

TOWER CASE

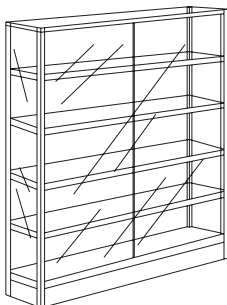

WALLCASE SOLID
AND SEE-THRU

All showcases are 20" D x 38" H, have lights, locks, sliding mirror doors,
gray exterior, off-white interior aluminum frames.

4' showcases available upon request. (limited quantities)

Electrical hook-up is not included. Please order the outlet from electrical
contractor.

A \$50.00 charge per showcase for late orders and changes made at showsite.

All keys must be left with showcase or a charge of \$10.00 will be assessed.

A \$20.00 charge per additional shelf or size change of shelf.

Company Name: _____ Phone #: _____ Fax #: _____

Address: _____ City: _____ State: _____ Zip: _____

Authorized By (print): _____ Signature: _____ Booth #: _____

Order Summary and Payment Sheet MUST accompany this order. All terms and conditions as outlined on the Order Summary and Payment Sheet have been reviewed and understood.
RES Address: 9291 West Bryn Mawr Rosemont, IL 60018 • RES Telephone: 847-696-2208 • RES Fax: 847-696-9797